

TR103 VENDING MACHINE INSTRUCTIONS

Applicable:

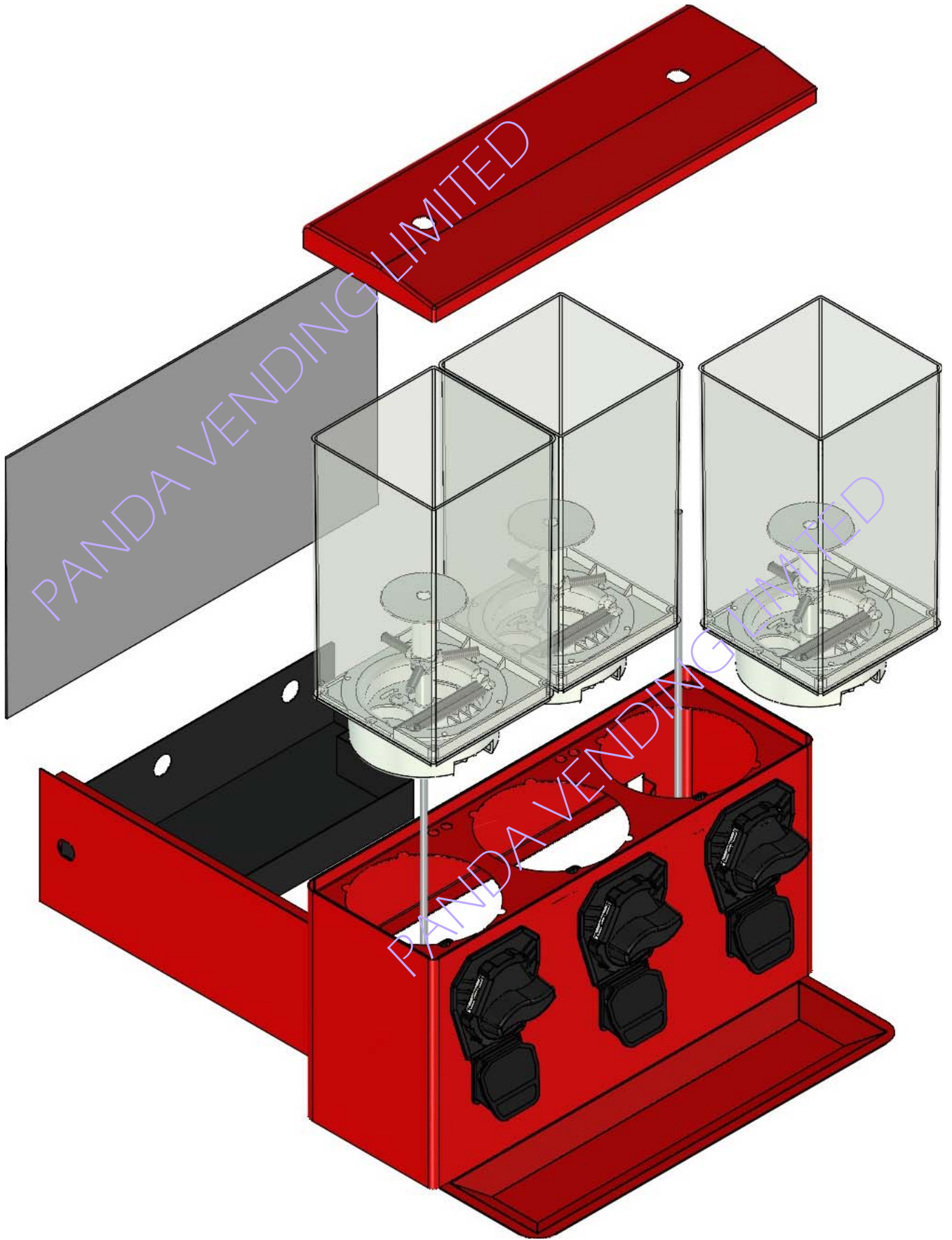

Initial set-up

1. To change wheels or wheel settings:

- A) Unlock and open globe lid by unscrewing lock.
- B) Remove four(4) post screws holding globe to hopper.(Fig.1)
- C) Remove candy brush plate from the hopper
- D) lift up adjuster plate and move to the desired wheel setting notch(fig.2). notch #1 (the notch to the far left) is for the smallest vends and notch#5 is for the largest vends. The adjuster plate can be completely removed if desired for vending large product such as peanut M&M.

Figure 1

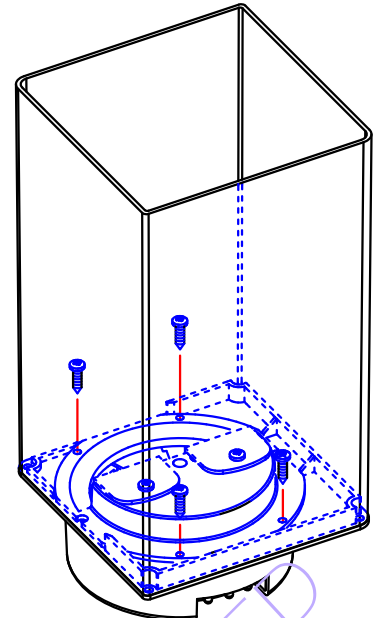
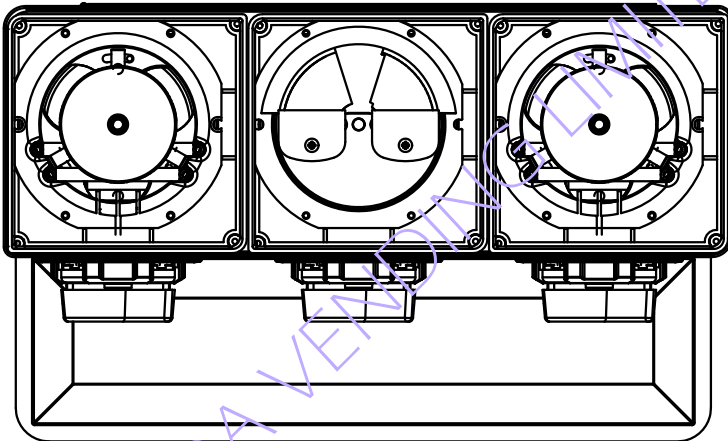

E) for gumballs or capsules, you will need to use the 1-3/8" gumball wheel and brush plate. The gumball wheel is installed by first installing the riser(Fig.3). The opening of the riser must face the front of the vendor. Next,install gumball wheel so that one of the vending holes is positioned over the opening in the riser, Install the gumball brush plate. Loosen the one(1) adjustment screw on top of the gumball wheel located next to each gumball cavity. Turn the adjustment wheel to adjust the opening according to the product being vended. The springs on the gumball brush plate must be towards the coin mechanism or the front of the vendor.

When your portion vends at the desired setting. continue filling the vendor with product. Replace the lid and install lock. **NOTE: DO NOT OVERTIGHTEN THE LOCK AS ONLY A SNUG FIT IS NECESSARY.**

Figure 2

Pan Candy Wheel

Candy Brush Plate

Adjuster Plate

Candy Wheel

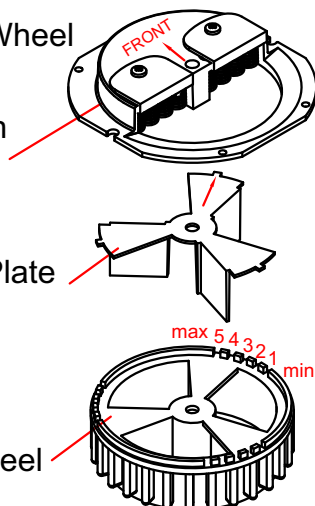

Figure 3

Gumball Wheel

Gumball Brush Plate

Adjuster Plate

Gumball Wheel

Adjuster Screw

Riser

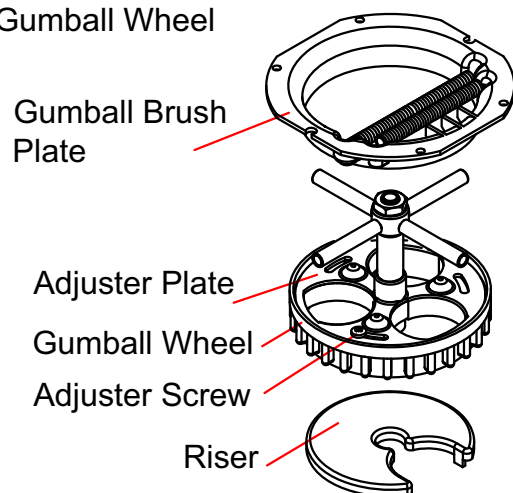

Coin Mechanism

The coin mechanism (Fig. 4) can be removed by removing the globe lid and lifting off the globe assembly. Once the globe assembly is removed, the coin mechanism can now be lifted upwards and removed.

1. To dismantle coin mechanism:

- A) Remove center screw.
- B) Remove sprocket.
- C) Remove three(4) mounting screws.
- D) Pull back plate away from face plate.
- E) Remove jammed coin.
- F) Replace parts in step A-F in reverse order.

Figure 4 coin mechanism Exploded view illustration for adjustment and maintenance only. coin mechanism parts not sold separately.

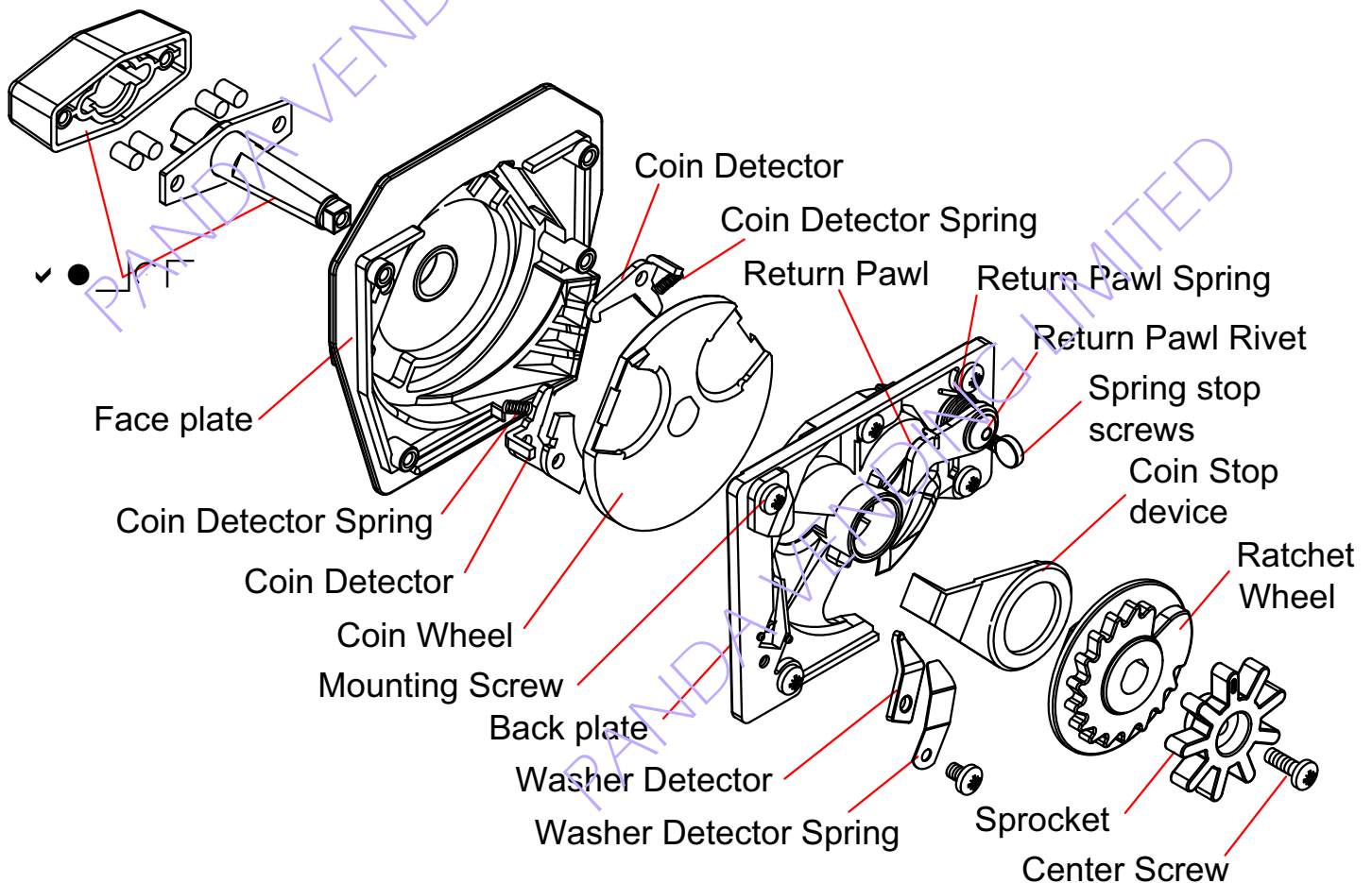

2. To retrieve coins:

- A) Unlock and unscrewing cash box lock, Pull cash box.
- B) Retrieve coin from cash box.
- C) Replace cash box.
- D) Replace and tighten cash box lock,

Note: do not overtighten the lock as only a snug fit is necessary.

Steel Stand Mounting

The Steel Stand itself consists of two(2)main parts.
The Base, Supporting tube.

1.For Single Mount:

- A. After opening back door and removing cashbox, the 4 mounting holes will be exposed.
- B. Push and press the Bevel End of the pole into the hole on the center of the round base.
- C. Put the machine on stand, and twist the 4 screws from machine bottom into the flange.

Figure 5 Steel Stand Mounting

Single Mount

