

How to Fix the Raw Material Bucket

Put the holdown groove of raw material

1 bucket shaft in rotation shaft.

- When feeding material, follow the relevant names of material in the bucket.
- In case of higher humidity please use heating band for prevention of solidification of raw material.

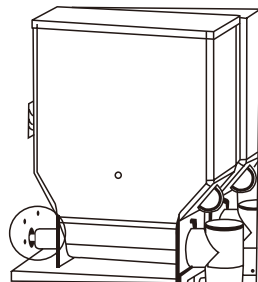

• In case of higher humidity in summer, using the heating band brings higher efficiency, but in winter it brings the reverse effect.

Replacement of Fuse

When the fuse burns off, replace it with a new one(AC220V,10A)

Replacement of the fuse is not included in the after-sale service.

Replacement of Power Fuse

1 Before replacement pull out the plug

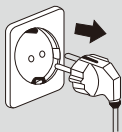

2 Open the cover of the fuse box.



3 Take out the fuse and put in the new one.



4 Screw light the cover.



Setting and Usage

The parameter of the water and powder is set at 1.0, when the machines come out of the factory. The parameter can be adjusted according to the clients' flavor.

Setting and choice of Drinks

1 A: When top water supply, to fill the water tank.

- Fill 3/4 of the water tank, while there is no water bucket, on the water tank.

B: When back water supply,

- Connection to the tap water
Using $\Phi 6$ PE pipe to connect the tap water to the water valve of the machine.

2 Put the power plug in the socket of 220V.

- ! Please use the grounded socket.
(Grounded plug for this machine)

3 Turn on the power switch at the back side of the machine.

- ★ NO WATER light is on with the noise of buzzer, the water valve starts to fill water into the water tank.
- ★ At this moment, the machine is under water heating status for about 4~5 minutes till the READY light is on. This time the water temperature is 80°C.

4 Place the cup beneath the dispensing nozzle after enough coins inserted.

Press the relevant bottom for the drink of your choice.

5 The drink is being dispensed when the light RUNNING is on. Take the drink away only after the RUNNING light is off.

NOTE: when the price for hot water is set on zero, the water dispensing is in the mode of manual operation only.

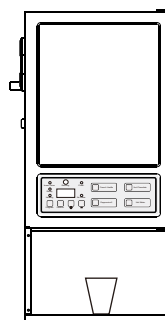
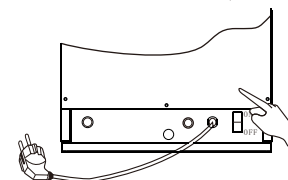
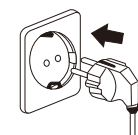
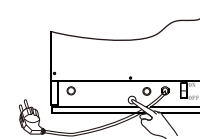

! **Caution:** Mode switch should be turned to position "OFF" before plug in.

Flavor setting/ setting of water

Appreciating taste of drinks can be adjusted by different hobby and remembered by the controlling program.

Adjustment of Drink Taste

- 1 Turn the Mode Function switch (Backside of Door) to position "ON", the Display shows "SE".

- 2 Press 'SET' button 8 times ,then the Display shows **AU.1** means setting sign for water volume(solenoid valve) of the sauce(seasoning)1 of the first drink. Customer can adjust appropriate water volume by "INCREASE" and "DECREASE" buttons here .
 Press the setting button again and the Display shows **AN.1**means setting sign for feeding volume of the electric motor of the seasoning 1 of the first drink. Customer can adjust appropriate raw material volume by "INCREASE" and "DECREASE" buttons here .
 Press the setting button once again and the Display shows **AU.2** means setting sign for the water volume(solenoid valve) of the potato powder of the first drink . Customer can adjust appropriate water volume by "INCREASE" and "DECREASE" buttons here .
 Press the setting button again and the Display shows **AN.2** means setting sign for feeding(potato powder) volume of the electric motor of the first drink , Customer can adjust appropriate raw material volume by "INCREASE" and "DECREASE" buttons here .

*** All the different parameter values mentioned below can be regulated by "INCREASE" and "DECREASE" buttons, and like so.**

Press the setting button 12 times ,the Display shows **BU.1** means setting sign for the water volume(solenoid valve) of the potato powder of the second drink.

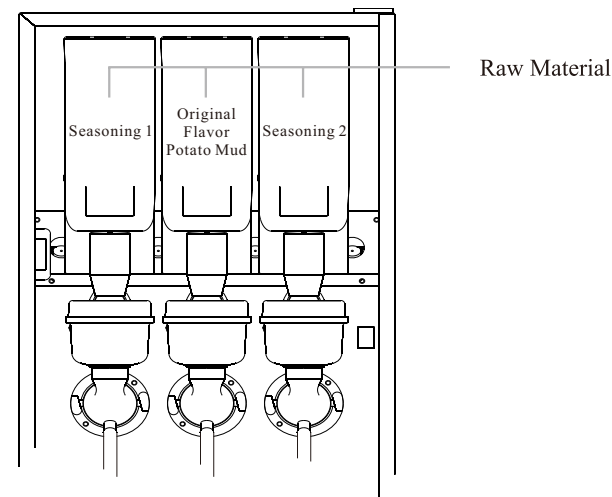
How to Place Raw Material



Dismount the raw material box first.

- 1 Rotate the T- shaped muff-joint to the graph 90° along the orientation of the arrow.

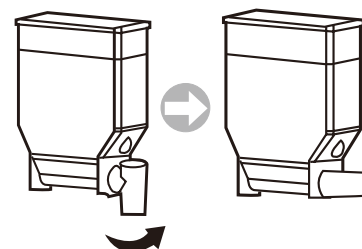

Raw Material Used

	Can be used	Can not be used
Raw Material	<ul style="list-style-type: none"> • Original Flavor Potato Mud • Seasoning 1 • Seasoning 2 	<ul style="list-style-type: none"> • liquid cream

- 2 Lift the front of the box lightly and pull it out.

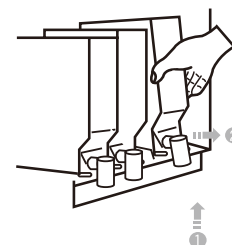

Instructions of Display Function

Display (as following chart) Function Instructions

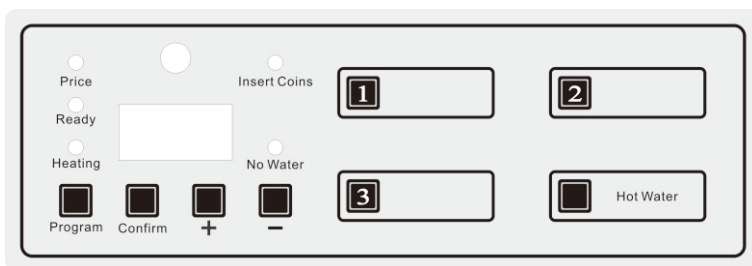

Numeroscope is composed of three digital displays. It shows the current working status or the information of current setting status of the machine. When the mode switch is switched ON, you can set the program; when it is OFF, the display shows the prices of drinks. The different LED stands for the working status of the machine. When you turn on the machine, the water is heated up with the light HEATING on. At this stage, the machine is not ready for use. The machine is ready to dispense drinks only when the light READY is on. (This time, the hot water temperature is 80°C)

Auto-cleaning of Feeding Pipe and Mixing Tank

Please clean the raw material beater and feeding pipe as usual as possible

Operation for cleaning

- 1 Push the mode function switch (at back side of the door) to "ON" position.
- 2 Press No.2 key on the panel.

※ With a vessel receive the cleaned water at the drink outlet. Take care not to burn by hot water.
To clean and sterilize with hot water at least once a day in order to prevent peculiar smell.

Flavor setting/ setting of water

Press once more time the button ,the Display shows **b7.1** means setting sign for feeding volume of the electric motor of the potato powder of second drink .

Press the setting button **14** times ,the Display shows **CU.1** means setting sign for the water volume(solenoid valve) of the sauce(seasoning)2 of the third drink.

Press once more time the button ,the Display shows **cn.1** means setting sign for feeding volume of the electric motor of the seasoning 2 of the third drink.

Press the setting button once again and the Display shows **CU.2** means setting sign for the water volume(solenoid valve) of the potato powder of the third drink.

Press the setting button again and the Display shows **cn.2** means setting sign for feeding(potato powder) volume of the electric motor of the third drink.

Press setting button **18** times, the Display shows **du.1** means setting sign the volume of hot water of solenoid valve.

Press setting button **19** times, the Display shows **EU.1** which sign for nothing ,please ignore it .

Drinks	First Drinks		Second Drinks	Third Drinks		Hot water
Material	Seasoning1 of First Drink	Potato powder of First Drink	Potato powder of Second Drink	Seasoning2 of Third Drink	Potato powder of Third Drink	
Water Volume	du.1	du.2	b7.1	CU.1	CU.2	du.1
Powder Volume	an.1	an.2	b7.1	cn.1	cn.2	

- 3 Having adjusted the taste ,the Confirm button should be pressed and the Mode Function switch (back of the door) turned to position "OFF",Display shows **P00**

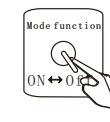

Setting for Water Temperature

Setting for Water Temperature

- 1 Turn the Mode Function switch (inside the machine) to position “ON”. The Display shows “SE”.

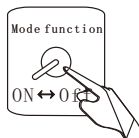

- 2 Press Programming button once, the Display will show **H.93**. Means upper limit temperature (The customer can adjust the temperature by INCREASE and DECREASE buttons here.) The adjusting range for temperature: 80°C~93°C. by pressing the INCREASE and DECREASE buttons to set the upper limit water temperature

! The allowed minimum difference between the upper and the lower temperature is 2°C

- 3 Press No.4 button once again, the display will show **L.85** means lower limit which can be set here by pressing INCREASE and DECREASE.

We advise to customers that the lower limit temperature of hot drinks should be set higher than 90 degrees Celsius.

The factory setting of temperature is 90 degrees Celsius for upper limit and 80 degrees Celsius for lower limit.

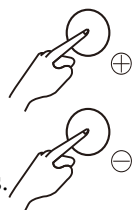

- 4 The confirm button on the Panel should be pressed after the setting is over and the Mode Function switch should be set to “OFF”, the display shows **P.00**.

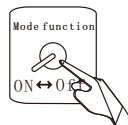

The temperature of hot water can be adjusted from 80 to 93 degrees Celsius and you can set different temperatures by season.

Introduction of Button Function on Operation Panel

Operation Panel

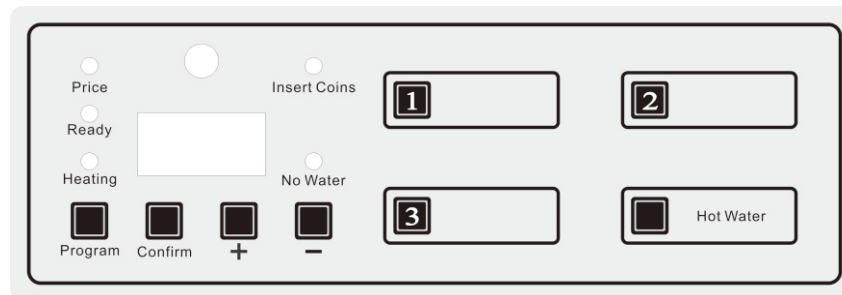

Self-checking Function

There is self-checking function with this coffee machine.

Turn the Mode Function switch (Backside of Door) to position “ON”, Display shows **SE** and the machine is in stand mode. Then press No.1 button once and display shows **EE** (means checking). Confirm Function button here and the machine starts to operate self-checking.

Checking sequence is as follows:

Water supply solenoid valve, mixing motor3, mixing motor2, mixing motor1, material feeding motor3, material feeding motor2, material feeding motor1.

Customer can clearly look over the running status of above components, to judge whether it works in good condition or not.

- Caution: 1. Self-checking should be operated before filling the material box and usually with the material box dismounted.
2. Pick the water at the drink outlet with a vessel.

Front Side

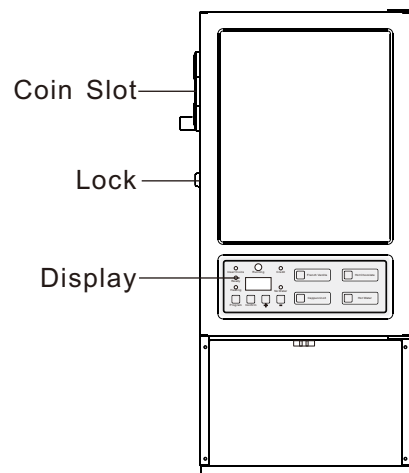

Back Side

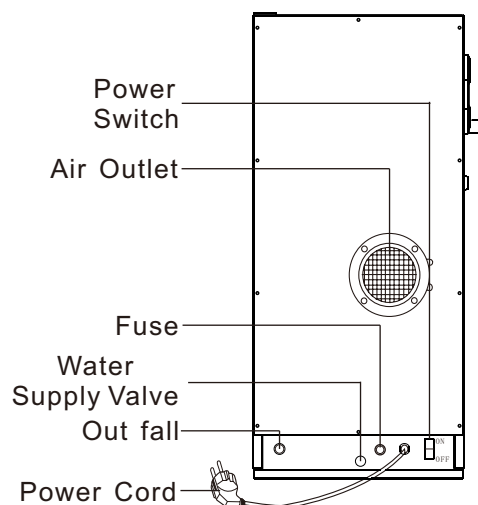

Inner Side

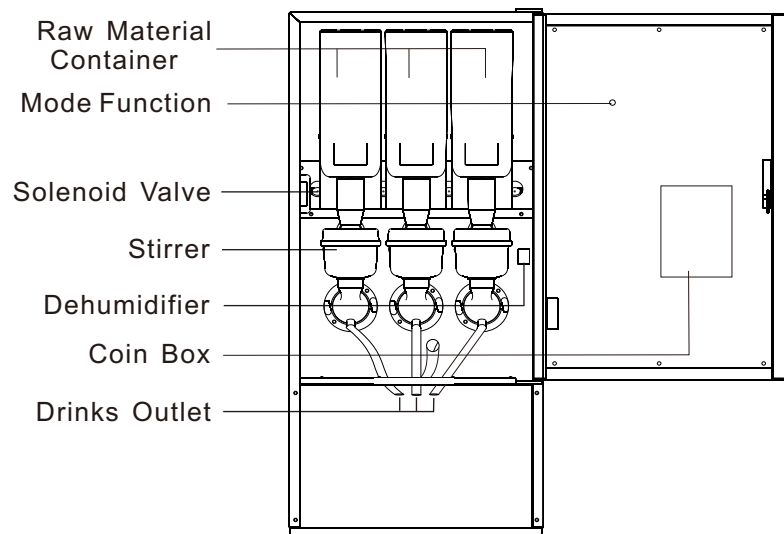

Setting of Unit Price

1 Turn the Mode Function switch (inside the machine) to position “ON”.

Display on the Panel shows “SET”.

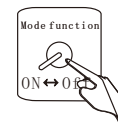

2 Press the “Confirm” button on the Panel 3 times.

▶ Display shows — **00** means the unit price for the First kind of drink.

Press the “Confirm” button on the front board 4 times.

▶ Display shows — **00** means the unit price for the Second kind of drink.

Press the “Confirm” button on the Panel 5 times

▶ Display shows — **00** means the unit price for the Third kind of drink.

Press the “Confirm” button on the Panel 6 times

▶ Display shows — **00** means the unit price for hot water.

Note: The marshaling sequence of Raw material box in the machine is Raw material 1,2,3 from left to right.

3 Press the “INCREASE” and “DECREASE” buttons to adjust prices

Press the bottom +/- on the panel to increase/decrease the unit price on the basis of nickle.



4 The Confirm button on Panel should be pressed after the setting is over and the Mode Function switch turned to position “OFF ”(The setting is over).

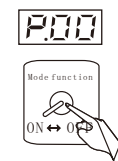

While Unit Price set as “00”, hot water volume control mode changes from auto mode to manual mode, that is to control water volume by the time of pressing.



The unit price of drink is on the basis of nickel, ranged from 0 to 99cents.



Sales Quantity Confirmation function

1 The sales quantity can be confirmed in the following way.

- 1** Turn the mode function switch (inside the machine)
to position “ON”.
The Display shows “SE”.



- 2** Press No.1 button twice until the sales quantity for the first kind of drinks displays.

The Display shows **1.00** first, about 2 second later it shows **000** and returns **1.00**

shows the first
kind of drink
the fifth figure of the
number of quantity
the forth figure of the
number of quantity

the third figure of the
number of quantity
the second figure of the
number of quantity
the first figure of the
number of quantity

Ex: If some kind of drink is sold 23263 cups and now you want to confirm
the sales quantity. While “SE” is displayed press No.1 button twice and
then the Display will show **1.23** for two seconds and follow to show **263**

When press No.1 button 3 times, sales quantity for second kind of drink will be
displayed.

When press No.1 button 4 times, sales quantity for third kind of drink will be
displayed.

... ..

The rest may be deduced by analogy.

- 3** Turn the Mode Function switch to position “OFF”.(The confirmation is over).

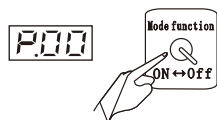

Work Before Use of Machine

- 1** Clean the machine. Connect the
water box. Connect the earth wire
(green). Connect the earth bar.
* Clean inside and outside of
the raw material tank.
* About cleaning, see Page 19

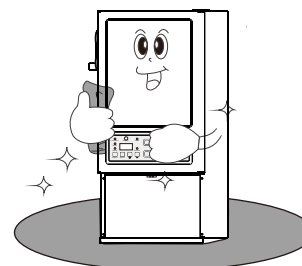

- 2** Place the machine from the wall at
least 10cm and choose the even
floor. The uneven floor is one of
causes of noise and poor working.

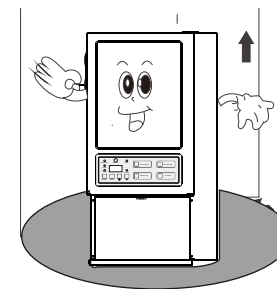

- 3** Put the water box to the
former place.

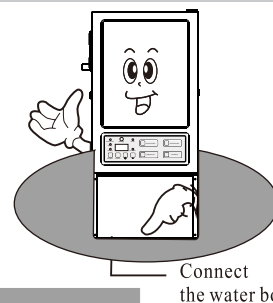

Connect
the water box

- 4** For the safety sake, please use a special
socket with earth wire.
* If you do not use the socket with earth wire,
please connect one end of the wire (green, a
copper wire over 1.6mm or soft wire over
1.25mm or over 2mm) and the other end to
copper plate or earth bar and bury it 30cm
deep. Be sure not to connect the wire to the
pipe of LPG. It is very dangerous.

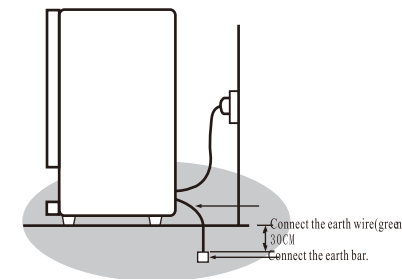

Accessory

2 keys	Operational manual /warranty card	Water receptacle	3 raw material tanks

Warning and Caution Marks



Warning

- Do not twist or pull or damage the power line. It will break the line and it is very dangerous.

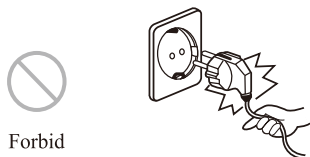

Forbid

- Do not put utensils with water on the top of the machine. The dripping water will decrease insulation and cause electric shock and fire.

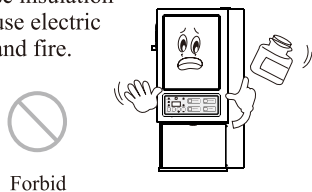

Forbid

- Do not put the machine in the humid place, otherwise insulation of electric articles may deteriorate and cause electric shock and fire.

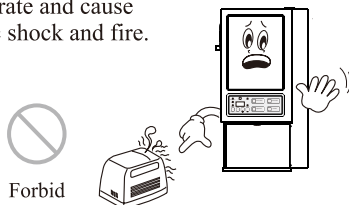

Forbid

- When replacing the fuse, pull out the power plug, otherwise there is danger of electric shock.

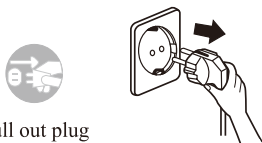

Pull out plug

- Please use a special socket of 220V. If the machine is used in the area of 110V, please use a step-up transformer in conformity with the capacity. If the designated transformer is not used, there is danger of fire and shock. The step-up transformer is to be bought separately (over 2KVA).

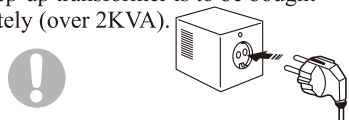

- Do not dismantle the machine, or it may cause shock or damage.

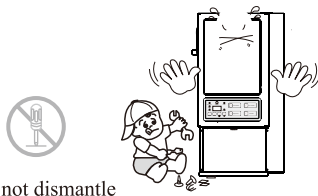

Do not dismantle

- Clean the metallic part of the power plug of the alien matter, or it may cause fire.

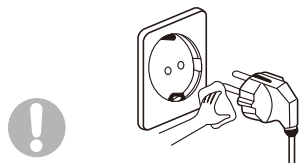

- When you find out that the hoses of socket are loosened, do not put the plug in, or it may cause shock and fire.

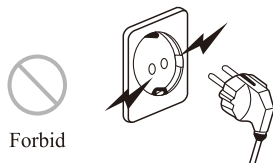

Forbid

Defect Confirmation

Phenomena and Confirmation

Does not start:

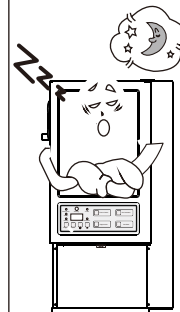

- Is the plug inserted?
- Be sure the power is 220V.
- Is the fuse broken?
- Contact the service center and replace it with a new one.

Raw material solidifies:

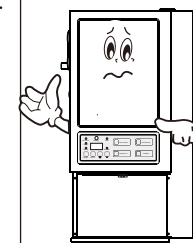

- Is the machine not in work for a long time? Pull out the plug and clean the material bucket.
- Does not the exhausting motor work due to foreign matter?
- If the exhaust fan does not work and humid in the machine can not be removed, please clean the exhaust pipe

Strong alien taste:

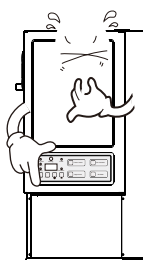

- Is the water in the water box long time?
- Pour out the water in the box and clean it.
- Did you clean the inside of the machine periodically?
- Did you not use the machine long time?
- Pull out the power plug and remove material and clean the machine.

Alien noise:

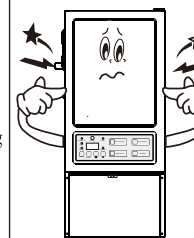

- Is the machine placed on slanting or uneven floor? Place the machine on the horizontal and even floor.
- Does the exhaust pipe have impurities and noise?
- Clean the pipe.
- If there is the sound of boiling?
- In order to keep the water temperature the heater is repeatedly started.

Drink does not flow out smoothly:

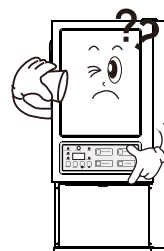

- Are particles or is sticky material used?
- Use only designated material.
- Is the material in the tank solidified?
- Dismantle the tank and clean it.
- Is the tank placed in the former position?
- Are the raw coffee mixer and tea passage stopped up?
- Clean the mixer and passage.
- Is the material in the tank used up?
- Fill in the material.

Dismantling of Parts

Dismantling of coffee material mixer

- 1 Pull up the top of the mixer and pull it out.
- 2 Turn the bottom of mixer clockwise and pull it out forward.

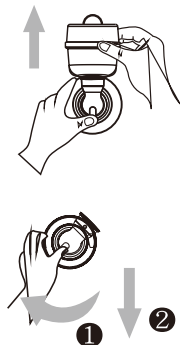

Dismantling of Water Tank

- 1 Pull out the soft hose and pull out the tap.
 - Remove all the water in the tank.
 - Turn off the power.
 - Take care against hot water.
- 2 Dismount the back cover with a crossdriver.
- 3 Pull out the hose of the tank.

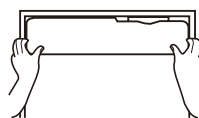
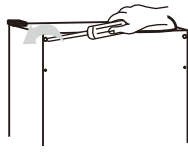

- 4 Pull out the water tank.



Caution: Just after beginning of water removal, the temperature is very high and you must be careful.

► Dismantling of the cover of fan



Caution: Turn off the power and dismantle the fan. Rotate the right knob and pull it out.

*When removing humid in the machine the powder moistened raw material will contaminate the fan cover and the exhaust fan and it is necessary to clean frequently.

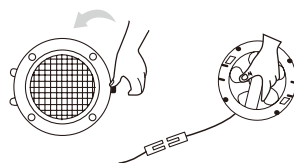

Warning and Caution Marks



Caution

• Do not give too much pressure onto the front operation position, otherwise deterioration of machine occurs.



Forbid



• Do not place the machine too close to the wall, otherwise there is poor exhaustion. If humid inside the machine does not get out, the raw material may solidify.



Forbid

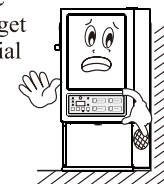

• Do not pull the power line for it may cause electric leak or shock by the damaged part of the line.



Forbid

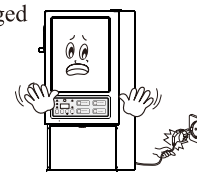

Do not place the machine opposite of the air-conditioner.
*It may be one of the causes of solidification of raw material from the material outlet.



Forbid

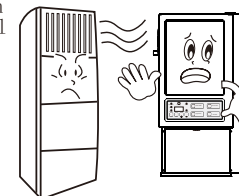

• Except for instant powder material, do not use other material. Usage of particles or sticky raw material such as peanut, tea, soup, gruel etc. for it may stop up the connecting passage.



Forbid

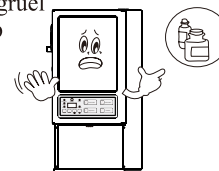

• Do not put your hand into under the bottom of the machine for it may cause injury by a sharp-edged.



Do not dismantle

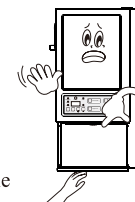

• When the machine is out of use for a long time (over 2 days), please pull out the plug. Otherwise it may cause fire because of overheating.



pull out the plug

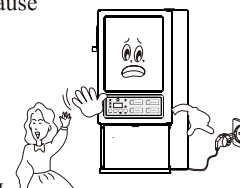

• If there is alien sound or smell, pull out the plug at once and contact with the sales center or the owner of store.





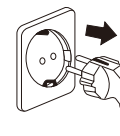









pull out the plug



Warning and Caution Marks

Safety is divided into warning and caution:

 This mark shows that violation of the requirements of operation may cause death or severe injury.	 This mark shows that violation of the requirements of operation may cause injury of human body or damage of house and other property.
 This mark shows that violation of the requirements of operation may cause death or severe injury.	 This mark shows that if put near inflammable gas or volatile, there is danger of explosion.
 will cause danger to remind probably.	 This mark shows that there is danger of electric shock.
 This mark show power plug is pulled out.	 This mark shows that one should not touch the hot spot.
 This mark shows impossibility of dismantle.	 This mark shows one should not touch functional positions.
 This mark shows to touch with the bare hand is not allowed.	 This mark shows if one does not use the nominal power, there is danger of fire.



Warning

When pouring water into the water tank, avoid spilling or leaking inside or onto the side of machine.

- Otherwise electric shock or fire may occur.

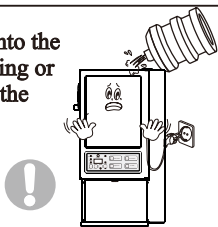

Do not pull or plug the power line with wet hand.

- Danger of electric shock.



Do not touch

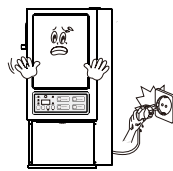

Avoid weighting down and damaging the power line.

- Danger of electric shock or fire because of electricity leak. Please use specific power socket.

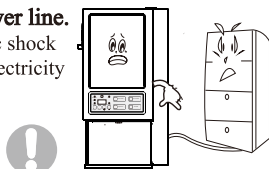

Do not connect several appliances to use socket.

- It may be cause of fire.



Forbid

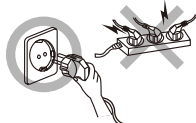

Cleaning

The raw material powder will fall and solidify inside the machine and the water on the receptacle is accumulated for long time and it causes a foreign taste and not Hygienic and therefore frequent cleaning is necessary. Pull out the plug before cleaning.

- Do not clean with chemicals such as benzene and zinc thinner.

* Water tank

Clean the inside spots of machine with soft sponge paper. Clean over 2 times per month.

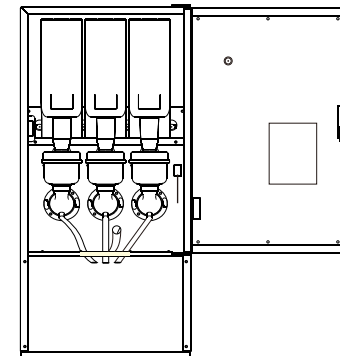
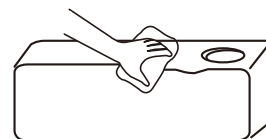

* Raw Material Bucket

Soak in water to solve the solidified material and clean it with soft sponge. Assemble after drying. Humid make material solidify and feeding be unsmooth. Clean over one time per month (or whenever material solidifies).

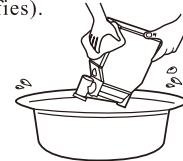

* Coffee Material Mixer

Soak it in water and clean it with a soft brush.

- After cleaning put it into the former place. Clean it once every day.

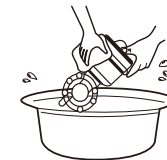

* Cup Hole

Clean it with wet cloth.

- Wipe water with dry cloth. Clean it once every day.



* Fan Cover in the Exhaust Hole

Soak it in water and wash the powder and dust of material and dry it.

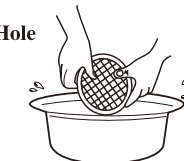

* Water Receiving Box

Pour out the accumulated water within the receptacle and soak in water and clean.

- After drying put it in the former position. Clean once every day.



* Exhaust Fan

Remove powder and dust of material with a brush and clean it with wet cloth.



Warranty card

Warranty Card

Customer's Evidence

1.The product is made under strict quality control and examination.
2.Under the normal usage of the product and within the warranty period,if defect(s) occurs, free maintenance is provided.
3.Even within the warranty period,if the damage is related with the charged service,maintenance is produced with charge.
4.When selling the product,the store worker must fill in the right column and then give it to the customer.
5.The warranty card is valid only within china.

Customer Information Column

Description of Product: Multifunctional Automatic Drinking Machine		Warranty Period:
Model : HV-302P		1 year
Date of Manufacture: y. m. d.		
Date of sell : y. M. d.		
Customer	Name	Tel
	Address	
Special Agent	Name	Tel
	Address	

Warranty Card

Special Agent Evidence

1.The product is made under strict quality control and examination.
2.Under the normal usage of the product and within the warranty period,if defect(s) occurs, free maintenance is provided.
3.Even within the warranty period,if the damage is related with the charged service,maintenance is produced with charge.
4.When selling the product,the store worker must fill in the right column and then give it to the customer.
5.The warranty card is valid only within china.

Main Points of Enjoying the After-sale Service: If the is abnormal phenomenon in the use, confirm it according to the "user's Manual" and contact Special Agent or Service Center and you will ge tqick reception and solution.Details of Contact:Description of product,model address, telephone number,defect and inconvenience in the use.

Description of Product: Multifunctional Automatic Drinking Machine		Warranty Period:
Model : HV-302P		1 year
Date of Manufacture: y. m. d.		
Date of sell : y. M. d.		
Customer	Name	Tel
	Address	
Special Agent	Name	Tel
	Address	

Placement



Do not place in the following place:

1

The slanting surface or uneven place.
Please place the machine in plain place



2

The dangerous place.
Avoid the place of fire danger.

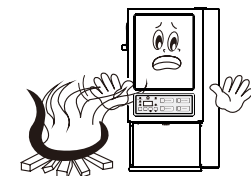

3

The place under direct light or rain and wind.
Please place it where there is no direct light and wind and rain.

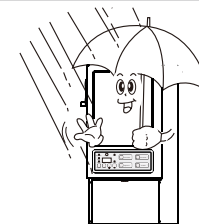

4

The noisy place.
Place it far from electrowaves and noise.

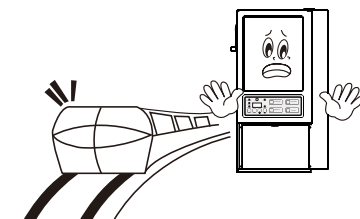

5

The place where there is sea wind (humid) or toxic gas:
Place it where is no influence.

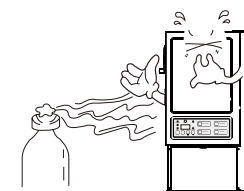

Contents

Specification	1
Placement	2
Warning and Caution Marks	3
Work Before Use Machine	6
Description of Components & Parts	7

Button Function on Operation Panel	8
Instructions of Display Function	9
How to Place Raw Material	10
How to Fix the Raw Material Bucket	11
Setting and Usage	12
Adjustment of Taste/Water Volume	13
Setting for Water Temperature	15
Setting of Unit Price	16
Sales Quantity Confirmation Function	17

Defect Confirmation	18
Dismantling of Parts	19
Cleaning	20
Warranty Card	21

Specification

Model	HV-302P
Power	AC220V 50Hz
Heater Power	1600W
Water Tank Volume	4L
Hot Liner Capacity	1.6 L
Display	LED/FND
Raw material	<ul style="list-style-type: none"> • Mashed potatoes • Seasoning
Size _(mm)	310×450×670
Weight	24 Kg

Important Explanation

If the machine is not used for a long time, please empty the machine (empty the machine with the drainpipe back on the machine). When the machine is placed with the environment under 0°C, the water kept inside the machine will cause hot liner, cool liner, water tank and other parts be frosted crack.

- ※ When not in use, cutting off power supply.
- ※ If wires are broken, it must be replaced by **the factory or some professional maintaining persons to avoid danger.**

Recipe(formula;dispensing) of Drinks

First Drink : (at first)Potato powder + (next)Seasoning1

Second Drink: Potato powder

Third Drink : (at first)Potato powder + (next)Seasoning2

Please see page 10 and page 13

Range of Free Maintenance

Within the warranty period (1year) and under normal use,if there is abnormal phenomenon,free maintenance is provided.

Range of Charged Maintenance

1. The warranty period has expired.
2. Within the warranty period:
 - Damage due to disasters such as fire,earthquake,flood,and abnormal power by lightning.
 - Damage caused by improper use of the machine.
 - The manufacture is by no means responsible for the safety Accident caused by the customer's Fault.



Instruction Manual

Model: HV-302P



The famous maker of mini-drinking machine www.happyline.net



Factory of Happyline in China:
661, QingXin South street, Changbai Road, Economic and Technical Development Zone of Yanji City, Jilin Province, China
Tel: 0433)282-9932 Fax: 0433)282-9329
Happyline Industrial & Trade Co., Ltd. of Qingdao,
306 C Block, SW World Trade Center, No 188 Heilongjiang Middle Road, chengyang, Qingdao
Tel: 0532) 8203-8726/8727 Fax: 0532) 8203-8728
After-Sale Service(A/S) Tel: 0433) 281-5597